

BEE HIVE

Design: Harrit-Sørensen



LE KLINT

MADE IN ODENSE, DENMARK SINCE 1943

Egestubben 13-17 • 5270 Odense N
www.leklint.com • leklint@leklint.dk

EN / DK



BEE HIVE

MODEL 303 · SMALL & MEDIUM

Please read before assembling the lamp
Læs venligst instruktionen først

LE KLINT

Instruktion
Instructions Manual

Instructions for BEE HIVE Models 303S / 303M

Please read through the instructions before you attempt to unpack and assemble the lamp

CONTENTS

Model 303 comes pre-assembled with hand-pleated paper shade on an oiled oak frame. The electrical cable attachment is included and is very easy to install by following the instructions below.

MAINTENANCE

Paper shade and wooden frame: Use a dust brush or a mild vacuum setting when cleaning. **Do not use any form of liquid or water on the pleated shade as it will dissolve. The paper cannot be repaired, but if damaged, you can purchase a new shade.**

LIGHT SOURCE

We recommend using an LED bulb to prevent heat damage to the paper shade. Recommended wattage: 303 small: 6W, 600 lumens and 303 medium: 7W, 800 lumens. **NB:** Max. wattage 20 W LED (E27).

Please follow your area's environmental recommendations for disposal of all used light sources.

UNPACKING

1. Read through the instructions carefully before you start.
2. Unpack the electrical cable attachment and place it on a flat surface/table top.
3. Lift out and place the cardboard insert on a flat surface/table top, then carefully pull then slide out the diffuser plate.
4. Place both hands inside the handles of the inner cardboard insert and pull up the safety packaging with the lamp, up out of the box.
5. Place the safety packaging and the lamp on the floor.
6. Grip the top parts of the legs and lift the lamp up onto a flat surface/table top, to avoid damaging the paper shade.

ASSEMBLY

7. Remove the socket ring from the socket.
8. Tilt the lamp and insert the socket from under the lamp.
9. Place the socket into the hole located in the center of the built-in frame.
10. Screw on the socket ring to secure the socket to the built-in frame.
11. Keep holding the underside of the socket as you turn and tighten the socket ring, to stop it from spinning around.
12. Fit a light bulb then place the diffuser plate on the top of the lamp onto the grooves.

HOW TO UNPACK BEE HIVE

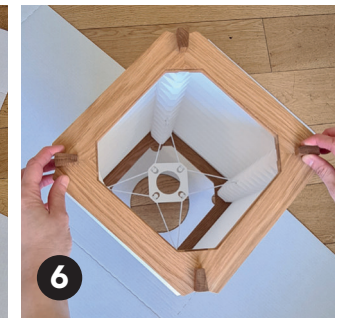
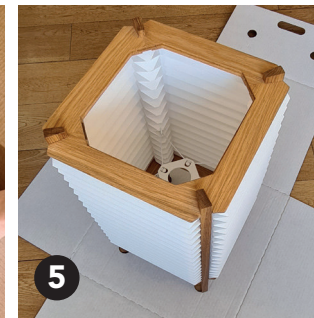
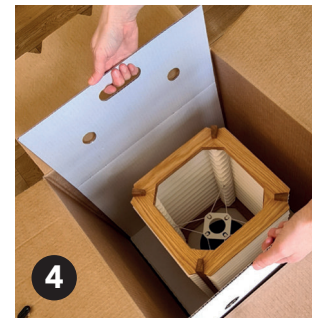
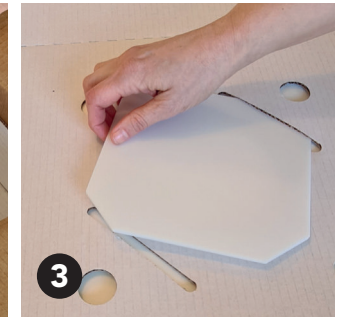
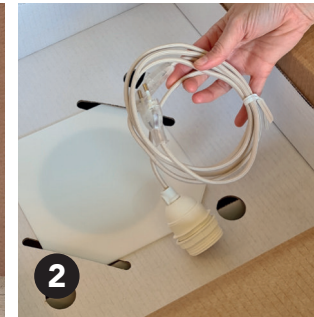

HOW TO ASSEMBLE BEE HIVE

